

REVISIONS				
REV.	ZONE	DESCRIPTION	DATE	BY
A		ADDED ECK9108	1/30/06	EJ
B		ADDED ECK10770	01/08	JFH

TERMINATION CHART

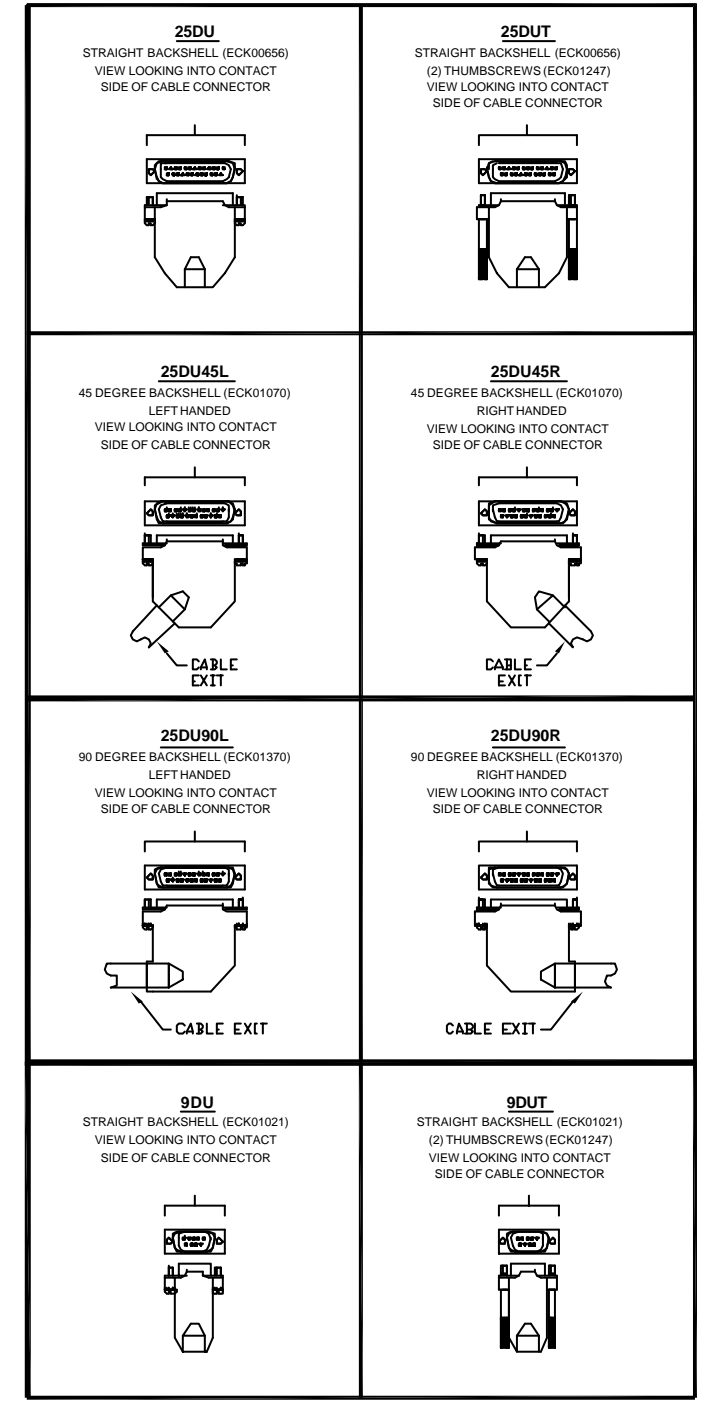

AMP PLUG, #745496-2 (ECK00786)
BACKSHELL: SEE TERMINATION CHART

PIN	WIRE	SIGNAL
13	BLU/BLK	BRAKE -
12	WHT	CW/+ LMT
11	GRY/RED	HALL C
10	GRY/BLK	HALL A
9	#22 RED/BLK	SETUP (-5V)
8	WHT/YEL	TACH-
7	BRN	MKR
6	WHT/BRN	MKR-N
5	WHT/GRY	HALL B
4	GRN/BLK	COMMON
3	#22 WHT/VIO	ENCODER +3V
2	BLK	EXT SD
1	OUTER SHLD	OUTER SHIELD
14	RED	COS
15	WHT/RED	COS-N
16	#24 RED/ORN	LIMIT +5V
17	ORN	SIN
18	WHT/ORN	SIN-N
19	YEL	TACH+
20	#24 BLK/ORN	LMT COMMON
21	#22 GRN	ENCODER COMMON
21	#22 WHT/GRN	AND
22	PINK	HOME LMT
23	YEL/BLK	ENCODER FAULT
24	GRY	CCW/- LMT
25	BLU	BRAKE +

AMP SOCKET, #745495-2 (ECK00789)
BACKSHELL: SEE TERMINATION CHART

SIGNAL	WIRE	SOCKET
SHIELD	OUTER SHLD	1
EXT SD	BLK	2
ENCODER +5V	#22 WHT/VIO	3
COMMON	GRN/BLK	4
HALL B	WHT/GRY	5
MKR-N	WHT/BRN	6
MKR	BRN	7
TACH-	WHT/YEL	8
SETUP (-5V)	#22 RED/BLK	9
HALL A	GRY/BLK	10
HALL C	GRY/RED	11
-	-	12
BRAKE -	BLU/BLK	13
-	-	14
BRAKE +	BLU	25
-	-	24
ENCODER FAULT	YEL/BLK	23
-	-	22
ENCODER COMMON	#22 GRN	21
-	#22 WHT/GRN	21
-	-	20
TACH+	YEL	19
SIN-N	WHT/ORN	18
SIN	ORN	17
-	-	16
COS-N	WHT/RED	15
COS	RED	14
INNER SHIELD	INNER SHLD	N.C.

AMP SOCKET, #745491-2 (ECK00781)
BACKSHELL: SEE TERMINATION CHART

SIGNAL	WIRE	SOCKET
LMT +5V	#24 RED/ORN	1
LMT CON	#24 BLK/ORN	2
CW/+ LMT	WHT	3
HOME LMT	PINK	4
CCW/- LMT	GRY	5
LIMIT SHIELD	LMT SHIELD	CASE

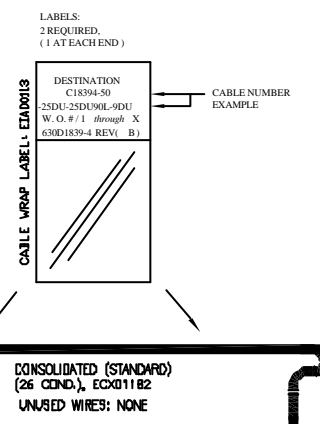

CONSOLIDATED (STANDARD) (26 COND.), ECK01182
UNUSED WIRES: NONE

CONTROL END

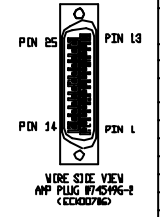

MOTOR END

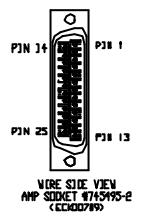

LIMITS

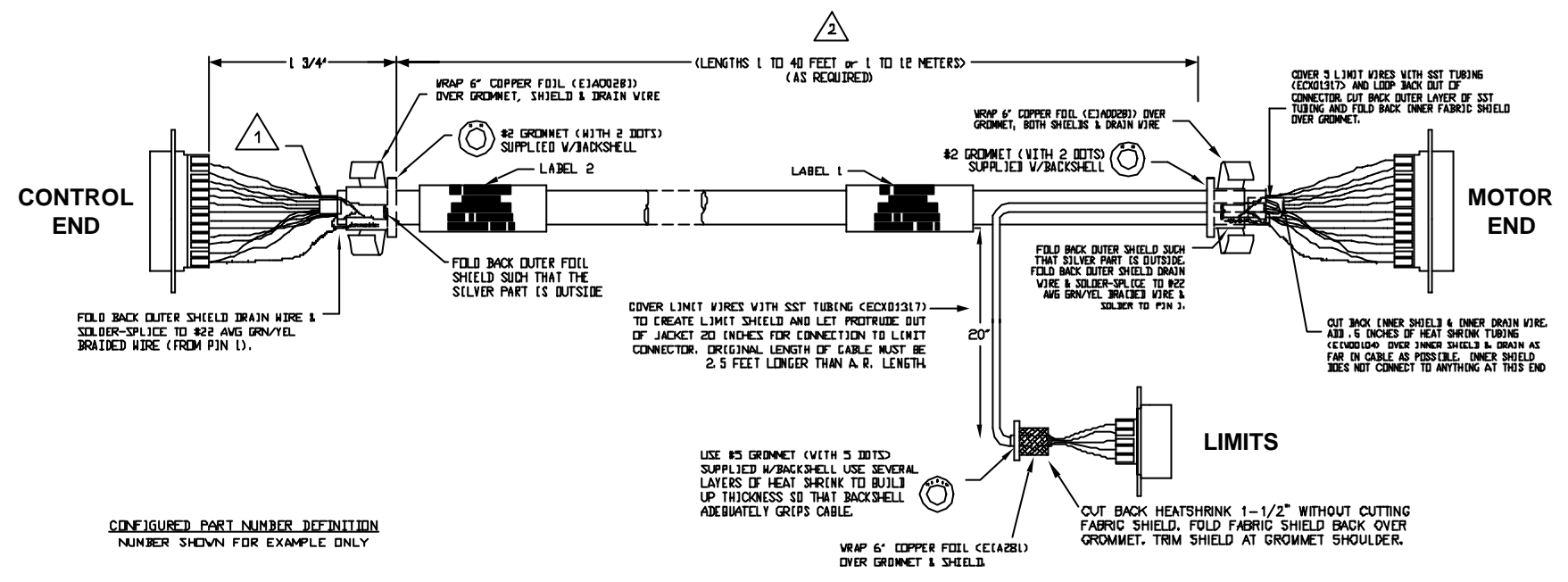
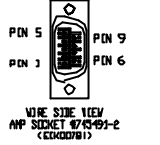

- LIMITS - MOTOR END (1)**
9DU - STRAIGHT BACKSHELL
9DUT - STRAIGHT BACKSHELL w/THUMBSCREWS
- MOTOR END (1)**
25DU - STRAIGHT BACKSHELL
25DUT - STRAIGHT BACKSHELL w/THUMBSCREWS
25DU45L - 45 DEGREE BACKSHELL - LEFT HAND
25DU45R - 45 DEGREE BACKSHELL - RIGHT HAND
25DU90L - 90 DEGREE BACKSHELL - LEFT HAND
25DU90R - 90 DEGREE BACKSHELL - RIGHT HAND
- CONTROL END (1)**
25DU - STRAIGHT BACKSHELL
25DUT - STRAIGHT BACKSHELL w/THUMBSCREWS
25DU45L - 45 DEGREE BACKSHELL - LEFT HAND
25DU45R - 45 DEGREE BACKSHELL - RIGHT HAND
25DU90L - 90 DEGREE BACKSHELL - LEFT HAND
25DU90R - 90 DEGREE BACKSHELL - RIGHT HAND
- LENGTH (1)**
xx - WHERE xx = LENGTH IN DECIMETERS
- BASE PART (1)**
C18394-50-25DU-25DU90L-9DU

- CONFIGURED CABLE PROCEDURE:**
- THE PURPOSE OF THIS DRAWING IS TO DEFINE VARIOUS BACKSHELL AND SCREWLOCK TYPES AS REQUIRED BY THE SHOP TRAVELLER.
- LOCATE THE SHOP TRAVELLER FOR CABLE TO BE MANUFACTURED.
 - USING SHOP TRAVELLER AND TERMINATION CHART AT RIGHT:
 - DETERMINE "CONTROL END" TERMINATION.
 - DETERMINE "MOTOR END" TERMINATION.
 - DETERMINE "LIMITS" TERMINATION.
 - USING THE ABOVE INFORMATION, MANUFACTURE CABLE WITH APPROPRIATE TERMINATIONS.
 - LABEL CABLE WITH NEW CONFIGURED PART NUMBER, FOLLOWING THE "CONFIGURED PART NUMBER DEFINITION" SHOWN TO THE LEFT.

- 1 UNWRAP INNER FOIL SHIELD AS FAR BACK AS POSSIBLE. SEPARATE GREEN WIRE (INSULATION, SOLDER-SPLICE WHT/GRN & INNER DRAIN WIRES TO GREEN WIRE. WRAP INNER FOIL SHIELD OVER SOLDER-SPLICE. COVER INNER SHIELD, SPLICE & INNER FOIL WITH SHRINK TUBING AS FAR IN CABLE AS POSSIBLE. CONNECT GREEN WIRE TO PIN 2).
- NOTE: INNER SHIELD MUST NOT TOUCH OUTER SHIELD OR BACKSHELL.
-
- 2 STARTING CABLE LENGTH = 2.5 FT BEYOND SPECIFIED LENGTH OF CABLE DO NOT EXCEED LENGTH OF 40 FT FOR THIS DESIGN
- 3 FOR CRIMP TOOL USE AMP HANDLE ASSY 58074-1 WITH AMP HEAD ASSY 58063-2

WORK ORDER #: XXXXXX
 CUSTOMER NAME: XXXXXXXXXXXXX
 ORDER NUMBER: XXXXXX
 APPROVED BY: XXX
 RELEASE DATE: XX/XX/XX CUST FILE NAME: XXXXXX 630D1839-4B1.dwg

PROPRIETARY INFORMATION
 THIS DRAWING IS THE PROPERTY OF AEROTECH, INC. AND IS SUBMITTED IN CONFIDENCE AND SHALL NOT BE REPRODUCED NOR COPIED NOR DISCLOSED TO OTHERS UNDER PENALTY OF LAW.

AEROTECH, INC. 101 Zeta Drive
 Pittsburgh, PA. 15238
 (412)963-7470
 www.aerotech.com

CONFIGURED BRUSHLESS FEEDBACK CABLE
 CABLE: BL FB-25DU-25DU 9DU-MAXI20DM

REV.	DATE	BY	SCALE	FILE NAME	SHEET	OF
DRWN	EJ	11/4/04				
CHECKED	JLJ	11/4/04				
APPD	JLJ	11/4/04				