

REVISIONS			
REV.	DESCRIPTION	DRAWN	DATE

PIN	WIRE	SIGNAL
13	GRN	BRK-
12	WHT	CW/+ LMT
11	-	-
10	-	-
9	-	-
8	-	-
7	DRN	MKR
6	DRN/WHT	MKR-N
5	-	-
4	WHT/BRN	Stage ID
3	#24 VIO	ENC +5V
2	-	-
1	#22 GRN/WHT	SIG SHLD

14	YEL	COS
15	YEL/WHT	COS-N
16	#24 RED	LMT +5V
17	BLU	SIN
18	BLU/WHT	SIN-N
19	-	-
20	#24 BLK	LMT COM
21	#24 GRY	ENC COM
22	BRN/WHT	HM LMT
23	-	-
24	WHT/GRY	CCW/- LMT
25	WHT/GRN	BRK+

SIGNAL	WIRE	PIN	
SIN-N	BLU/WHT	H	
BRK+	WHT/GRN	J	
SIN	BLU	G	
Stage ID	WHT/BRN	K	
HM LMT	BRN/WHT	W	
CCW/- LMT	WHT/GRY	V	
CW/+LMT	WHT	U	
COS-N	YEL/WHT	F	
MKR	ORN	L	
MKR-N	ORN/WHT	X	
SIG SHLD	#22 GRN/WHT	Z	
BRK-	GRN	T	
COS	YEL	E	
ENC +5V	#24 VIO	M *	
LMT +5V	#24 RED	-	
MTR SHLD	#22 GRN/WHT	Y	
MTR A	MTR A-CT	#22 BLK	R
FRM GND	#22 GRN/YEL	S	
LMT COM	#24 BLK	-	
ENC COM	#24 GRY	D *	
MTR B	MTR B	#22 RED	N
-	-	-	P
MTR B-N	MTR B-CT	#22 WHT	A *
-	-	-	B
MTR A-N	MTR A'	#22 WHT	C



WIRE SIDE VIEW

BURNDY PLUG ECK00135
CLAMP BURNDY ECK00617

#28-22 SOCKETS BURNDY ECK00402
CRIMP TOOL: BURNDY HANDLE W/HEAD ASSY N20RT-29

OR
BURNDY CRIMPER
MODEL UTM-2R W/HEAD ASSY CM11G1R

* = #20-16 SOCKETS BURNDY ECK00403
CRIMP TOOL: BURNDY HANDLE W/HEAD ASSY N16RT-24

- 3 WIRE MARKERS
FLAG WIRES WITH BRADY LABELS, COMPUTER FILE NO. 630C2025-101.
- 2 USE 2" LENGTHS OF THICK WALL HEATSHRINK TUBING TO BUILD UP CABLE DIAMETER FOR PROPER STRAIN RELIEFING. STRAIN RELIEFING MUST WITHSTAND 35 LB. PULL.
CUT THICK WALL HEATSHRINK TUBING WITH CABLE CUTTER SUCH THAT ENDS ARE PERPENDICULAR TO CABLE AND CUT IS SMOOTH.
THICK WALL HEATSHRINK TUBING:
EIW00112 MAX INSIDE DIA = .750" (EXPANDED), MIN INSIDE DIA = .220" (RECOVERED)
EIW00113 MAX INSIDE DIA = .400" (EXPANDED), MIN INSIDE DIA = .150" (RECOVERED)
- 1 STARTING CABLE LENGTH = A. R. LENGTH + 17 IN.

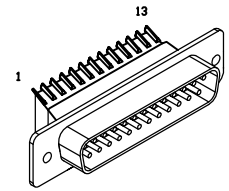

25 PIN D MALE ECK00786
BACKSHELL ECK00656
FOR CRIMP TOOL USE AMP HANDLE ASSY 58074-1
WITH AMP HEAD ASSY 58063-2

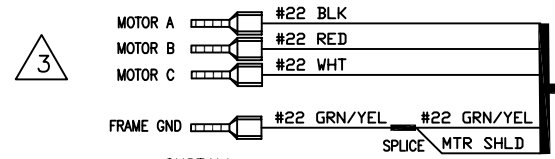

INSTALL FERRULES, EIK01085 WITH APPROPRIATE TOOLING.

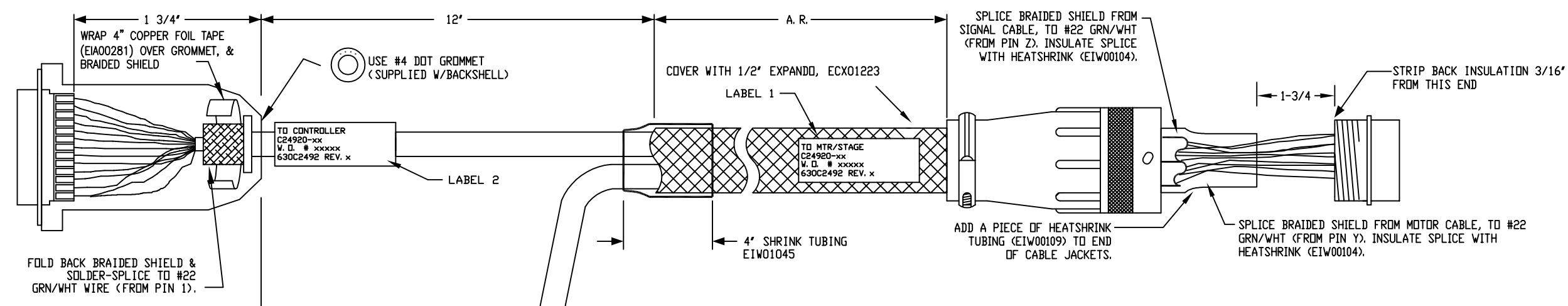
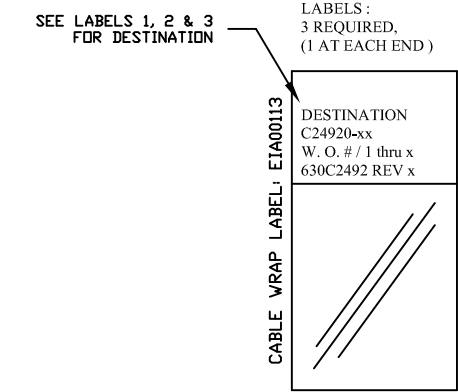

PROPRIETARY INFORMATION THIS DRAWING IS THE PROPERTY OF AEROTECH, INC. AND IS SUBMITTED IN CONFIDENCE AND SHALL NOT BE REPRODUCED NOR COPIED NOR DISCLOSED TO OTHERS UNDER PENALTY OF LAW.		AEROTECH, INC. 101 Zeta Drive Pittsburg, PA. 15238 (412)963-7470 www.aerotech.com	
STEPPER MOTOR CABLE To Ndrive CABLE:SM MTR & FB-25DU 23B-HF-MAX120DM			
TOLERANCES ON FRACTIONS DECIMALS ANGLES 0 TO 6 ± 1/32 .XX ± .01 ± 0-30' OVER 6 ± 1/16 .XXX ± .005		RMS FINISH <input checked="" type="checkbox"/> EXCEPT AS NOTED	
DRAWN	11/6/2014	JFM	PART CODE
CHECKED	11/6/2014	TES	SIZE
APPD.	11/6/2014	JFM	SCALE NTS
FILE NAME 630C249201.Dwg		SHEET 1 OF 1	

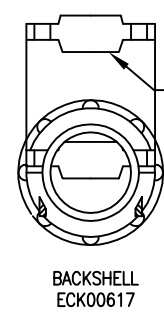

INSERT STRAIN RELIEF WITH APPROPRIATE SIDE FACING CABLE TO PROPERLY STRAIN RELIEF CABLE